

**DESIGN REPORT**

- Legend:**
- City Boundary
  - Proposed Development Boundary
  - Proposed Road Development
  - ESB overhead 110kV
  - ESB overhead 38kV
  - ESB underground 38kV
  - ESB LV Overhead Single Phase
  - ESB LV Overhead Three Phase
  - ESB MV Overhead Single Phase
  - ESB MV Overhead Three Phase
  - ESB MV / LV Underground Cable
  - Existing Gas Networks Services
  - Existing Underground Eir Services
  - Existing Overhead Eir Services
  - ESB HotSpot highlighted by Eir Services
  - Existing BT Service
  - Existing ENet Service
  - Existing Three Service Sites

San áiríamh tá sonraíochtaí Shairbhéiríochtaí Ordánais Éireann arna aistriú go dtí físeán OSI Uimh. 2010/18CCMA/Comhairle Contae na Gaillimhe. Sárúilom aistriú go dtí naomhárúil na císcheart Shairbhéiríochtaí Ordánais Éireann agus Rialtas na hÉireann. © Sairbhéiríochtaí Ordánais Éireann, 2010.

© Sairbhéiríochtaí Ordánais Éireann. Gach ceart ar chosaint. Uimhir cheadúnais 2010/18CCMA/Comhairle Contae na Gaillimhe.

Includes Ordnance Survey Ireland data reproduced under OSI Licence number 2010/18CCMA/Galway County Council. Unauthorised reproduction infringes Ordnance Survey Ireland and Government of Ireland copyright. © Ordnance Survey Ireland, 2010.

© Ordnance Survey Ireland. All rights reserved. Licence number 2010/18CCMA/Galway County Council.

**Clients**

**Comhairle Contae na Gaillimhe**  
Galway County Council

**N6 Galway City Transport Project**

**An Roinn Iompair Turasóireachta agus Spóirt**

**TIIP**

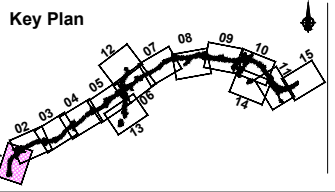

**Consultant**

**ARUP**

Corporate House  
City East Business Park  
Ballybrit, Galway, Ireland.

Tel +353 (0)91 460675  
www.NGalwayCity.ie  
www.arup.ie

**Job Title**  
N6 Galway City Ring Road

**Scale**  
1:5000 @ A3

**Date:**  
February 2018

Issue	Date	By	Chkd	Appd
11	22/02/2018	KJ	MH	EMC

**Drawing Title**  
Existing ESB, Gas & Telecom Utilities Network Plan  
CH.0+000 to CH.1+350  
Sheet 1 of 15

**Drawing Status**  
For Information

Job No	Drawing No	Issue
233985	GC08-2700-D-001	11

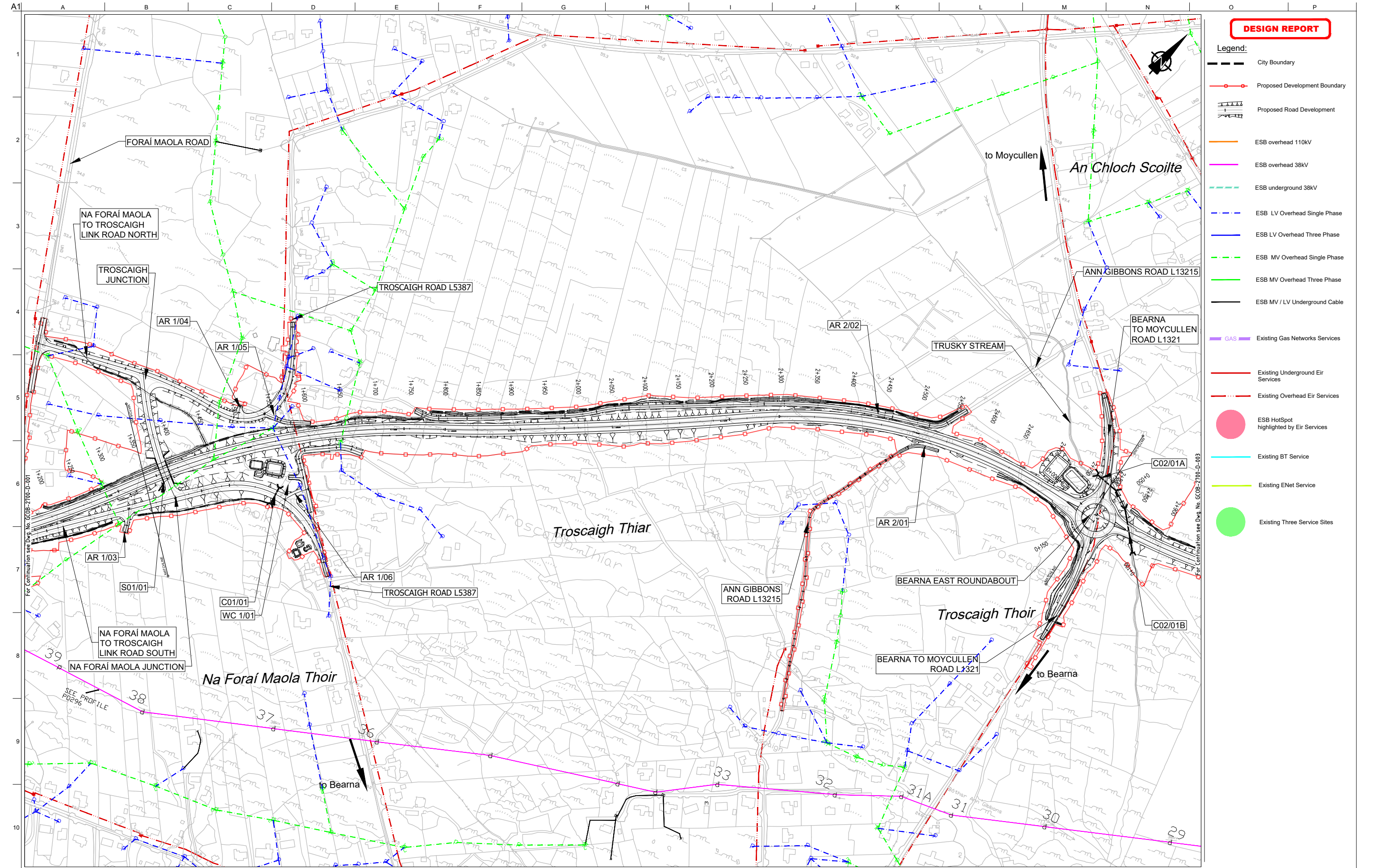

**DESIGN REPORT**

- Legend:**
- City Boundary
  - Proposed Development Boundary
  - Proposed Road Development
  - ESB overhead 110kV
  - ESB overhead 38kV
  - ESB underground 38kV
  - ESB LV Overhead Single Phase
  - ESB LV Overhead Three Phase
  - ESB MV Overhead Single Phase
  - ESB MV Overhead Three Phase
  - ESB MV / LV Underground Cable
  - GAS Existing Gas Networks Services
  - Existing Underground Eir Services
  - Existing Overhead Eir Services
  - ESB HotSpot highlighted by Eir Services
  - Existing BT Service
  - Existing ENet Service
  - Existing Three Service Sites

San áireamh tá sonraíochtaí Shairbhéiríochtaí Ordánais Éireann arna aistriú go dtí formáid OSI Umh. 2010/18CCMA/Comhairle Contae na Gaillimhe. Sáráilom aistriú go dtí formáid na císcheart Shairbhéiríochtaí Ordánais Éireann agus Rialtas na hÉireann. © Sairbhéiríochtaí Ordánais Éireann, 2010.

© Sairbhéiríochtaí Ordánais Éireann. Gach ceart ar chosaint. Umhír cheadnais 2010/18CCMA/Comhairle Contae na Gaillimhe.

Includes Ordnance Survey Ireland data reproduced under OSI Licence number 2010/18CCMA/Galway County Council. Unauthorised reproduction infringes Ordnance Survey Ireland and Government of Ireland copyright. © Ordnance Survey Ireland, 2010.

© Ordnance Survey Ireland. All rights reserved. Licence number 2010/18CCMA/Galway County Council.

Clients

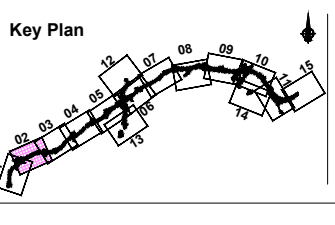

Consultant

Corporate House  
City East Business Park  
Ballybrit, Galway, Ireland.

Tel +353 (0)91 460675  
www.N6GalwayCity.ie  
www.arup.ie

Job Title  
**N6 Galway City Ring Road**

Scale  
1:5000 @ A3

Date:  
February 2018

Issue	Date	By	Chkd	Appd
11	22/02/2018	KJ	MH	EMC

Drawing Title  
Existing ESB, Gas & Telecom Utilities Network Plan  
CH.1+350 to CH.2+799  
Sheet 2 of 15

Drawing Status  
**For Information**

Job No	Drawing No	Issue
233985	GC0B-2700-D-002	11

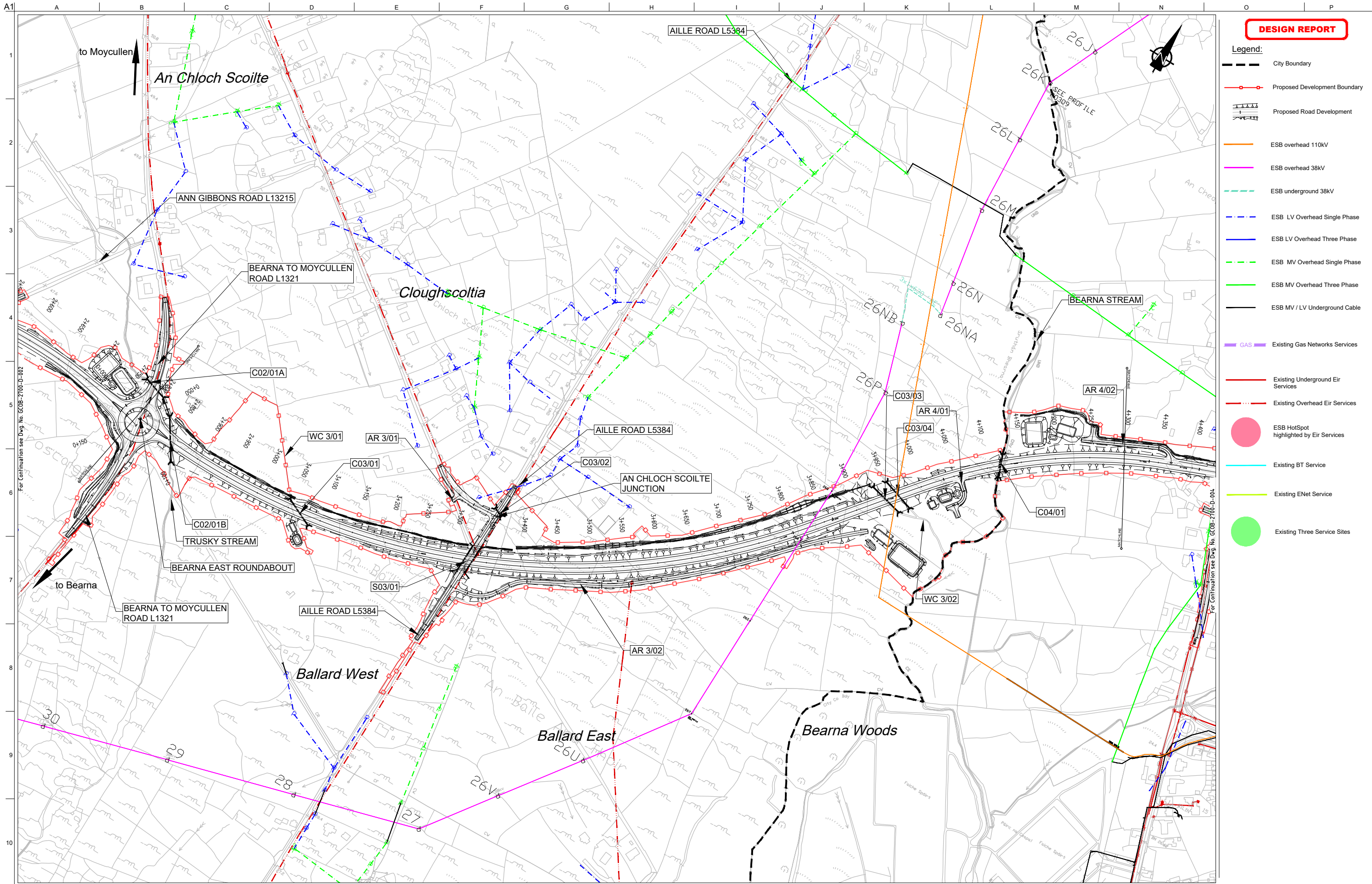

**DESIGN REPORT**

- Legend:**
- City Boundary
  - Proposed Development Boundary
  - Proposed Road Development
  - ESB overhead 110kV
  - ESB overhead 38kV
  - ESB underground 38kV
  - ESB LV Overhead Single Phase
  - ESB LV Overhead Three Phase
  - ESB MV Overhead Single Phase
  - ESB MV Overhead Three Phase
  - ESB MV / LV Underground Cable
  - GAS Existing Gas Networks Services
  - Existing Underground Eir Services
  - Existing Overhead Eir Services
  - ESB HotSpot highlighted by Eir Services
  - Existing BT Service
  - Existing ENet Service
  - Existing Three Service Sites

San áiríamh tá sonraíochtaí Shairbhéireachtaí Ordánais Éireann arna aistriú go dtí físeán OSI Uimh. 2010/18CCMA/Comhairle Contae na Gaillimhe. Sáráilom aistriú go dtí na h-áiríamh na h-Éireann agus Rialtas na hÉireann. © Sairbhéireachtaí Ordánais Éireann, 2010.

© Sairbhéireachtaí Ordánais Éireann. Gach ceart ar chosaint. Uimhir cheadnáis 2010/18CCMA/Comhairle Contae na Gaillimhe.

Includes Ordnance Survey Ireland data reproduced under OSI Licence number 2010/18CCMA/Galway County Council. Unauthorised reproduction infringes Ordnance Survey Ireland and Government of Ireland copyright. © Ordnance Survey Ireland, 2010.

© Ordnance Survey Ireland. All rights reserved. Licence number 2010/18CCMA/Galway County Council.

**Clients**

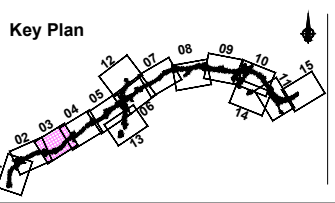

**Consultant**

Corporate House  
City East Business Park  
Ballybrit, Galway, Ireland.

Tel +353 (0)91 460675  
www.NGalwayCity.ie  
www.arup.ie

**Job Title**  
N6 Galway City Ring Road

**Scale**  
1:5000 @ A3

**Date:**  
February 2018

Issue	Date	By	Chkd	Appd
11	22/02/2018	KJ	MH	EMC

**Drawing Title**  
Existing ESB, Gas & Telecom Utilities Network Plan  
CH.2+799 to CH.4+300  
Sheet 3 of 15

**Drawing Status**  
For Information

Job No	Drawing No	Issue
233985	GC0B-2700-D-003	11

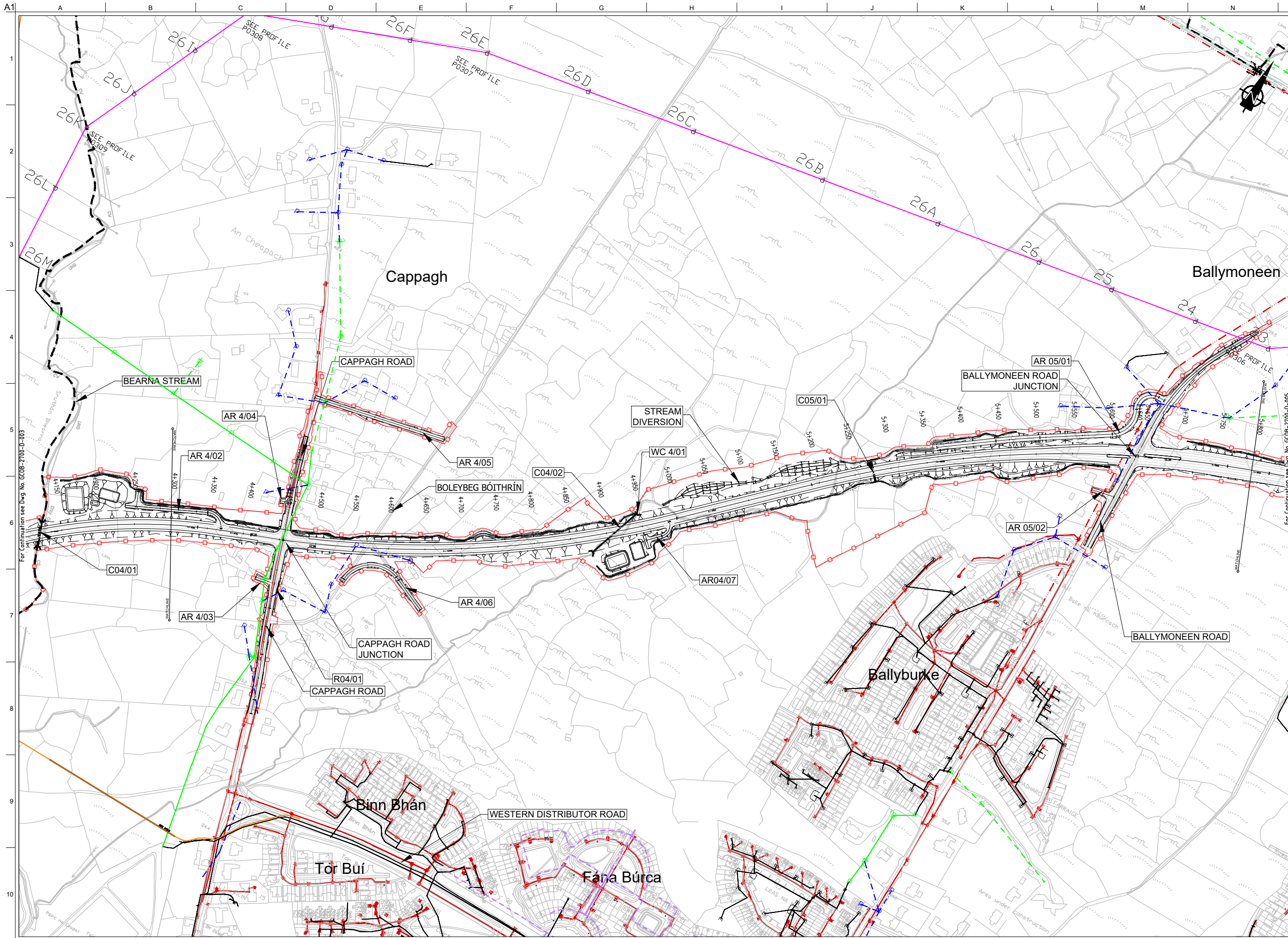

**DESIGN REPORT**

- Legend:**
- City Boundary
  - Proposed Development Boundary
  - Proposed Road Development
  - ESB overhead 110kV
  - ESB overhead 38kV
  - ESB underground 38kV
  - ESB LV Overhead Single Phase
  - ESB LV Overhead Three Phase
  - ESB MV Overhead Single Phase
  - ESB MV Overhead Three Phase
  - ESB MV / LV Underground Cable
  - GAS Existing Gas Networks Services
  - Existing Underground Eir Services
  - Existing Overhead Eir Services
  - ESB HotSpot highlighted by Eir Services
  - Existing BT Service
  - Existing ENet Service
  - Existing Three Service Sites

San áiríamh tá sonraíochtaí Shairbhíreachtúcháirle Éireann arna aistriú go dtí faoi Cheadúnas OSI Uimh. 2010/18CCMA/Comhairle Contae na Gaillimhe. Sárúilom aistriú go dtí na h-áiríamh agus Rialtas na hÉireann. © Sairbhíreachtúcháirle Éireann, 2010.

© Sairbhíreachtúcháirle Éireann. Gach coart ar chosaint. Uimhir cheadúnais 2010/18CCMA/Comhairle Contae na Gaillimhe.

Includes Ordnance Survey Ireland data reproduced under OSI Licence number 2010/18CCMA/Galway County Council. Unauthorised reproduction infringes Ordnance Survey Ireland and Government of Ireland copyright. © Ordnance Survey Ireland, 2010.

© Ordnance Survey Ireland. All rights reserved. Licence number 2010/18CCMA/Galway County Council.

**Clients**

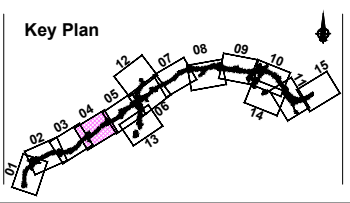

**Consultant**

Corporate House  
City East Business Park  
Ballybrit, Galway, Ireland.

Tel +353 (0)91 460675  
www.NGalwayCity.ie  
www.arup.ie

**Job Title**  
N6 Galway City Ring Road

**Scale**  
1:5000 @ A3

**Date:**  
February 2018

Issue	Date	By	Chkd	Appd
11	22/02/2018	KJ	MH	EMC

**Drawing Title**  
Existing ESB, Gas & Telecom Utilities Network Plan  
CH.4+300 to CH.5+800  
Sheet 4 of 15

**Drawing Status**  
For Information

Job No	Drawing No	Issue
233985	GC0B-2700-D-004	11

**DESIGN REPORT**

- Legend:**
- City Boundary
  - Proposed Development Boundary
  - Proposed Road Development
  - ESB overhead 110kV
  - ESB overhead 38kV
  - ESB underground 38kV
  - ESB LV Overhead Single Phase
  - ESB LV Overhead Three Phase
  - ESB MV Overhead Single Phase
  - ESB MV Overhead Three Phase
  - ESB MV / LV Underground Cable
  - GAS Existing Gas Networks Services
  - Existing Underground Eir Services
  - Existing Overhead Eir Services
  - ESB HotSpot highlighted by Eir Services
  - Existing BT Service
  - Existing ENet Service
  - Existing Three Service Sites

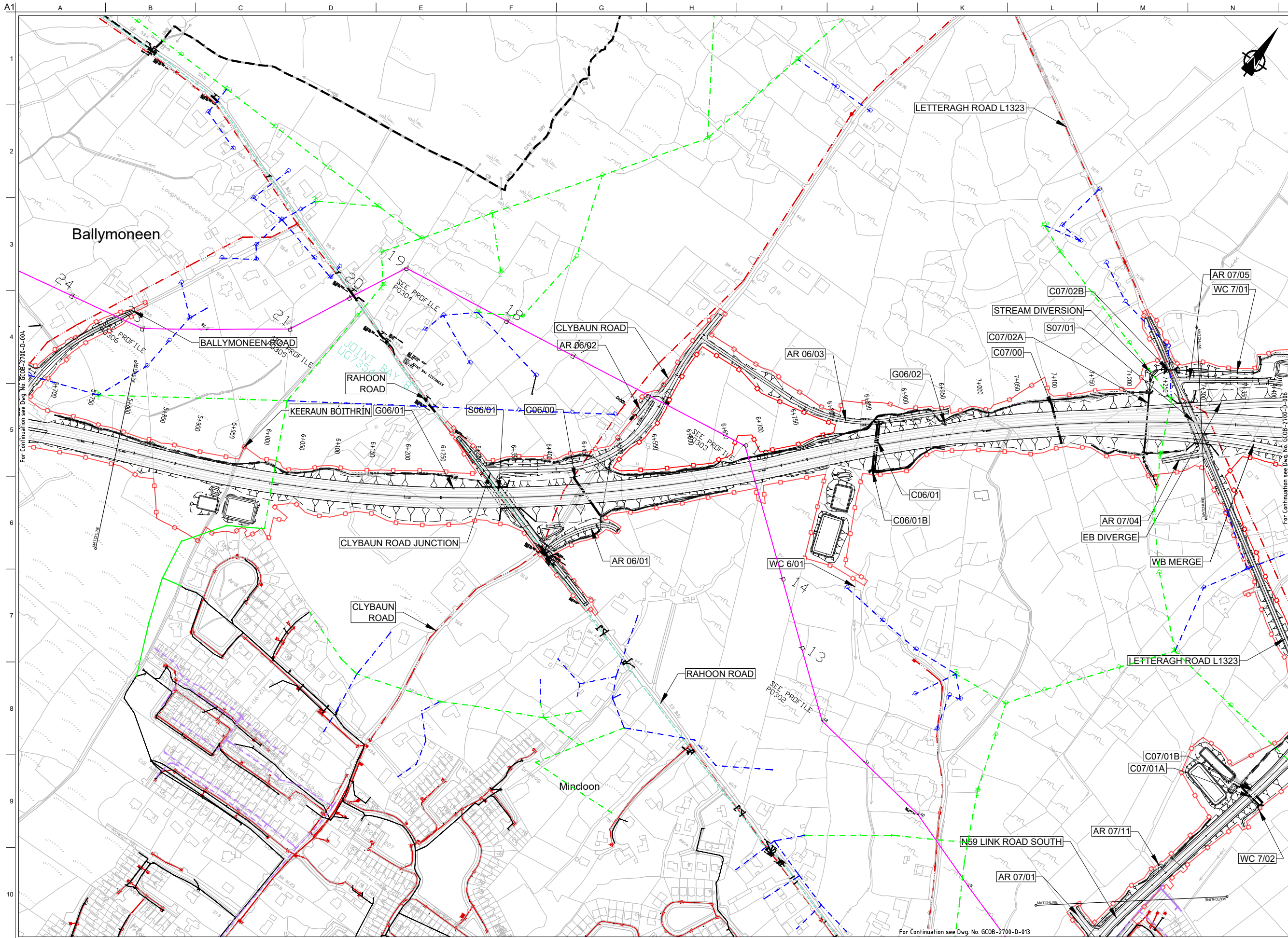

San áiríamh tá sonraíochtaí Shairbhéiríochtaí Ordánais Éireann arna aistriúchadh faoi Cheadúnas OSI Uimh. 2010/18CCMA/Comhairle Contae na Gaillimhe. Sárúilom aistriúchadh namhárúil arís na cíoscheart Shairbhéiríochtaí Ordánais Éireann agus Rialtas na hÉireann. © Sairbhéiríochtaí Ordánais Éireann, 2010.

© Sairbhéiríochtaí Ordánais Éireann. Gach ceart ar chosaint. Uimhir cheadúnais 2010/18CCMA/Comhairle Contae na Gaillimhe.

Includes Ordnance Survey Ireland data reproduced under OSI Licence number 2010/18CCMA/Galway County Council. Unauthorised reproduction infringes Ordnance Survey Ireland and Government of Ireland copyright. © Ordnance Survey Ireland, 2010.

© Ordnance Survey Ireland. All rights reserved. Licence number 2010/18CCMA/Galway County Council.

**Clients**

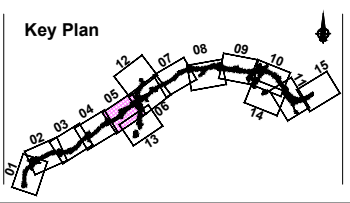

**Consultant**

Corporate House  
City East Business Park  
Ballybrit, Galway, Ireland.

Tel +353 (0)91 460675  
www.N6GalwayCity.ie  
www.arup.ie

**Job Title**  
N6 Galway City Ring Road

**Scale**  
1:5000 @ A3

**Date:**  
February 2018

Issue	Date	By	Chkd	Appd
11	22/02/2018	KJ	MH	EMC

**Drawing Title**  
Existing ESB, Gas & Telecom Utilities Network Plan  
CH.5+800 to CH.7+300  
Sheet 5 of 15

**Drawing Status**  
For Information

Job No	Drawing No	Issue
233985	GCOB-2700-D-005	11

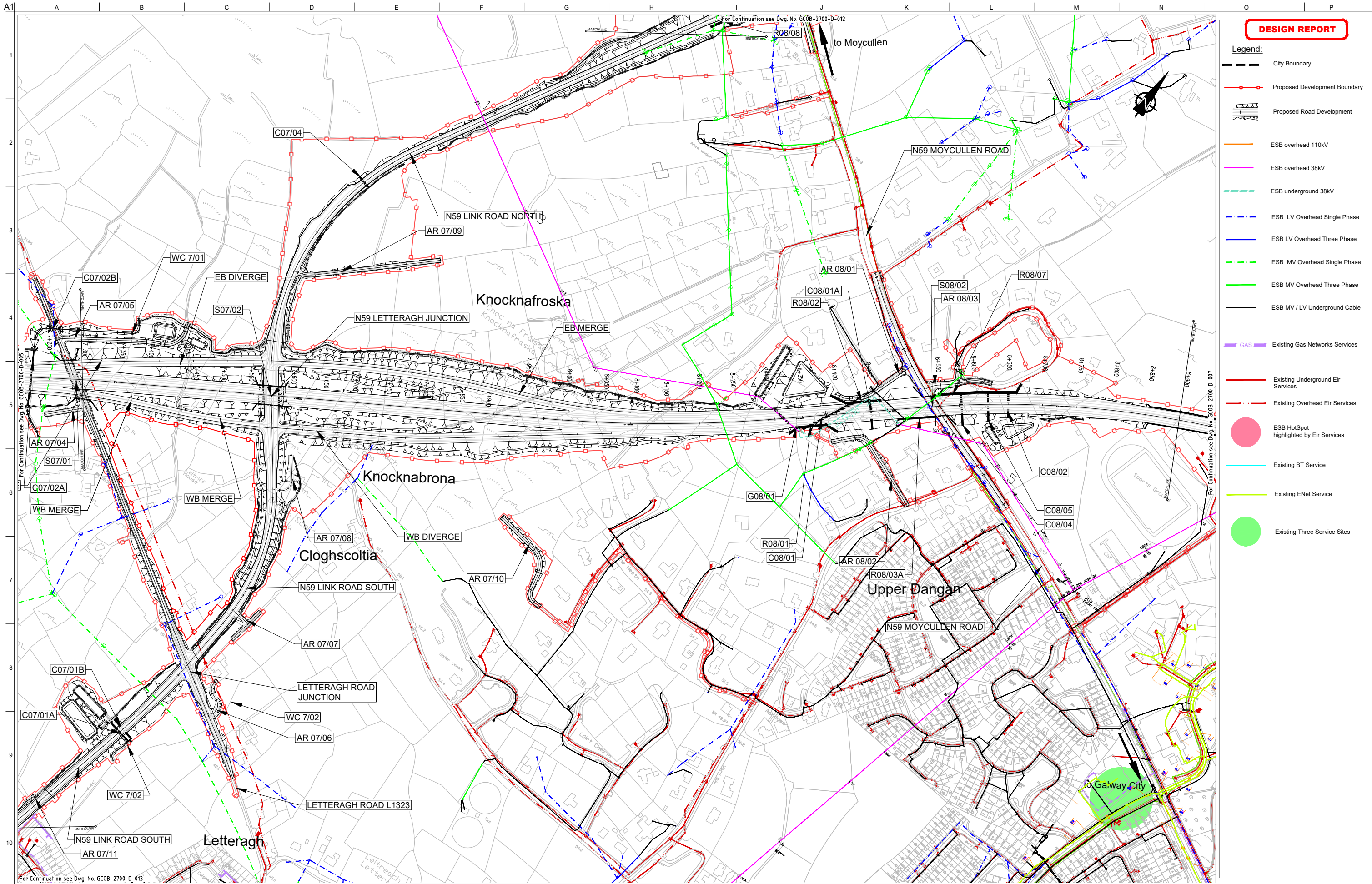

**DESIGN REPORT**

- Legend:**
- City Boundary
  - Proposed Development Boundary
  - Proposed Road Development
  - ESB overhead 110KV
  - ESB overhead 38KV
  - ESB underground 38KV
  - ESB LV Overhead Single Phase
  - ESB LV Overhead Three Phase
  - ESB MV Overhead Single Phase
  - ESB MV Overhead Three Phase
  - ESB MV / LV Underground Cable
  - Existing Gas Networks Services
  - Existing Underground Eir Services
  - Existing Overhead Eir Services
  - ESB HotSpot highlighted by Eir Services
  - Existing BT Service
  - Existing ENet Service
  - Existing Three Service Sites

San áiríonn sé sonraíochtaí Shairbhíreachtú Ordnáis Éireann arna aistriú go dtailí faoi Chleasúnas OSI Uimh. 2010/18CCMA/Comhairle Contae na Gaillimhe. Sárúilom aistriú go dtailí na cíoscheart Shairbhíreachtú Ordnáis Éireann agus Rialtas na hÉireann. © Sairbhíreachtú Ordnáis Éireann, 2010.

© Sairbhíreachtú Ordnáis Éireann. Gach ceart ar chosaint. Uimhir cheadúnais 2010/18CCMA/Comhairle Contae na Gaillimhe.

Includes Ordnance Survey Ireland data reproduced under OSI Licence number 2010/18CCMA/Galway County Council. Unauthorised reproduction infringes Ordnance Survey Ireland and Government of Ireland copyright. © Ordnance Survey Ireland, 2010.

© Ordnance Survey Ireland. All rights reserved. Licence number 2010/18CCMA/Galway County Council.

Clients

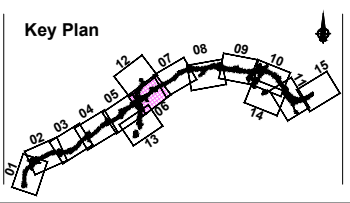

Consultant

Corporate House  
City East Business Park  
Ballybrit, Galway, Ireland.

Tel +353 (0)91 460675  
www.N6GalwayCity.ie  
www.arup.ie

Job Title  
**N6 Galway City Ring Road**

Scale  
1:5000 @ A3

Date  
February 2018

Issue	Date	By	Chkd	Appd
11	22/02/2018	KJ	MH	EMC

Drawing Title  
Existing ESB, Gas & Telecom Utilities Network Plan  
CH.7+300 to CH.8+900  
Sheet 6 of 15

Drawing Status  
**For Information**

Job No <b>233985</b>	Drawing No <b>GCOB-2700-D-006</b>	Issue <b>11</b>
-------------------------	--------------------------------------	--------------------

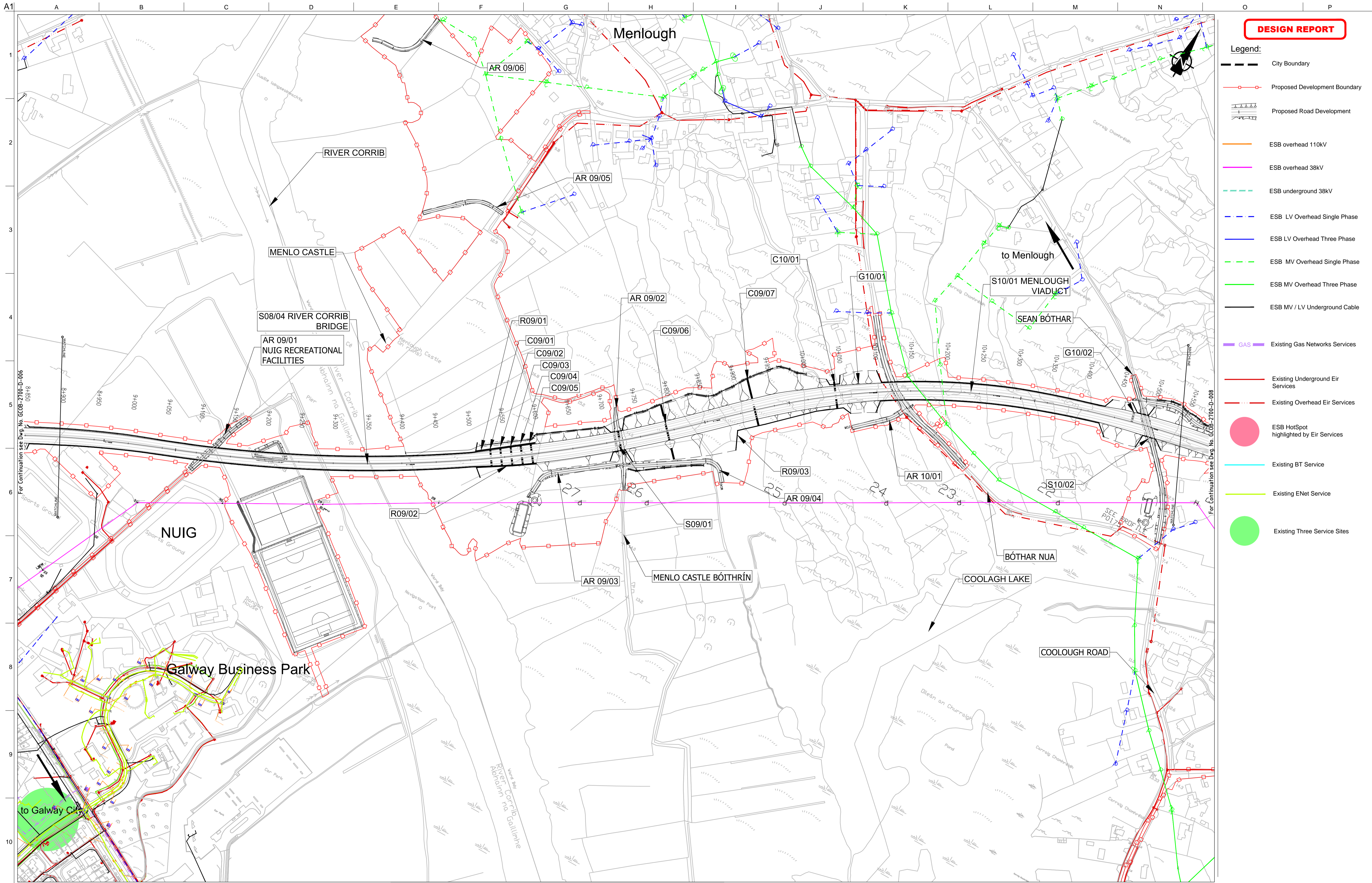

**DESIGN REPORT**

- Legend:**
- City Boundary
  - Proposed Development Boundary
  - Proposed Road Development
  - ESB overhead 110kV
  - ESB overhead 38kV
  - ESB underground 38kV
  - ESB LV Overhead Single Phase
  - ESB LV Overhead Three Phase
  - ESB MV Overhead Single Phase
  - ESB MV Overhead Three Phase
  - ESB MV / LV Underground Cable
  - GAS Existing Gas Networks Services
  - Existing Underground Eir Services
  - Existing Overhead Eir Services
  - ESB HotSpot highlighted by Eir Services
  - Existing BT Service
  - Existing ENet Service
  - Existing Three Service Sites

San áiríamh tá sonraíocht Shuirbhíreachtóirí Orlándaí Éireann arna aistriú go dtí foirm Cheadúnas OSI Uimh. 2010/18CCMA/Comhairle Contae na Gaillimhe. Sírtaíonn aistriú go dtí foirm Cheadúnas OSI Uimh. 2010/18CCMA/Comhairle Contae na Gaillimhe agus Rialtas na hÉireann. © Suirbhíreachtóirí Orlándaí Éireann, 2010.

© Suirbhíreachtóirí Orlándaí Éireann. Gach ceart ar chosaint. Uimhir cheadúnas 2010/18CCMA/Comhairle Contae na Gaillimhe.

Includes Ordnance Survey Ireland data reproduced under OSI Licence number 2010/18CCMA/Galway County Council. Unauthorised reproduction infringes Ordnance Survey Ireland and Government of Ireland copyright. © Ordnance Survey Ireland, 2010.

© Ordnance Survey Ireland. All rights reserved. Licence number 2010/18CCMA/Galway County Council.

Clients

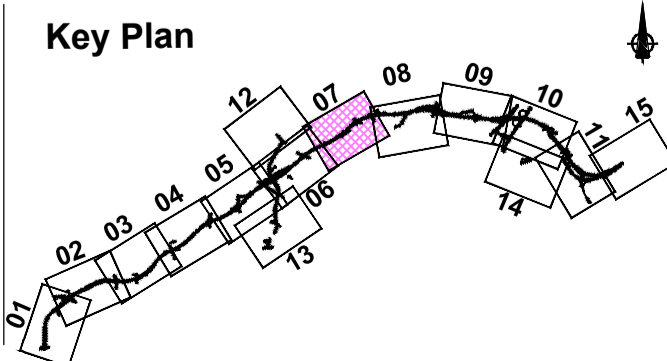

Consultant

Corporate House  
City East Business Park  
Ballybrit, Galway, Ireland.

Tel +353 (0)91 460675  
www.N6GalwayCity.ie  
www.arup.ie

Job Title  
**N6 Galway City Ring Road**

Scale  
1:5000 @ A3

Date  
February 2018

Issue	Date	By	Chkd	Appd
I2	20/03/2018	KJ	MH	EMC
I1	22/02/2018	KJ	MH	EMC

Drawing Title  
Existing ESB, Gas & Telecom Utilities Network Plan  
CH.8+900 to CH.10+550  
Sheet 7 of 15

Drawing Status  
**For Information**

Job No <b>233985</b>	Drawing No <b>GCOB-2700-D-007</b>	Issue <b>12</b>
-------------------------	--------------------------------------	--------------------

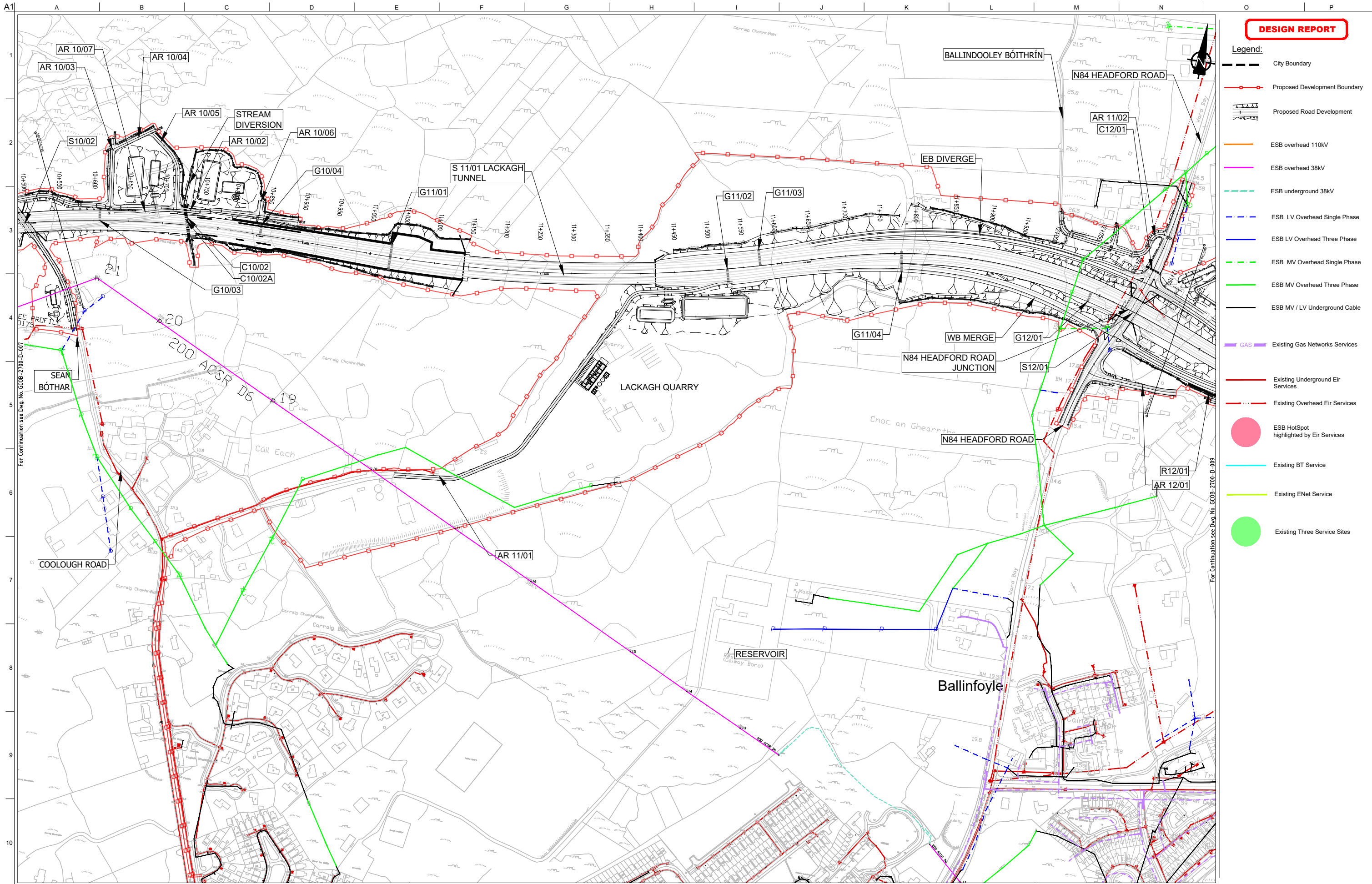

**DESIGN REPORT**

- Legend:**
- City Boundary
  - Proposed Development Boundary
  - Proposed Road Development
  - ESB overhead 110kV
  - ESB overhead 38kV
  - ESB underground 38kV
  - ESB LV Overhead Single Phase
  - ESB LV Overhead Three Phase
  - ESB MV Overhead Single Phase
  - ESB MV Overhead Three Phase
  - ESB MV / LV Underground Cable
  - GAS Existing Gas Networks Services
  - Existing Underground Eir Services
  - Existing Overhead Eir Services
  - ESB HotSpot highlighted by Eir Services
  - Existing BT Service
  - Existing ENet Service
  - Existing Three Service Sites

San áiríamh tá sonraíoch Shairbhéiríochtaí Ordánáis Éireann arna aistriú go dtí faoi Cheadúnas OSI Uimh. 2010/18CCMA/Comhairle Contae na Gaillimhe. Sárúil ar aistriú go dtí faoi cheadúnas na císchearta Shairbhéiríochtaí Ordánáis Éireann agus Rialtas na hÉireann. © Sairbhéiríochtaí Ordánáis Éireann, 2010.

© Sairbhéiríochtaí Ordánáis Éireann. Gach ceart ar chosaint. Uimhir cheadúnais 2010/18CCMA/Comhairle Contae na Gaillimhe.

Includes Ordnance Survey Ireland data reproduced under OSI Licence number 2010/18CCMA/Galway County Council. Unauthorised reproduction infringes Ordnance Survey Ireland and Government of Ireland copyright. © Ordnance Survey Ireland, 2010.

© Ordnance Survey Ireland. All rights reserved. Licence number 2010/18CCMA/Galway County Council.

**Clients**

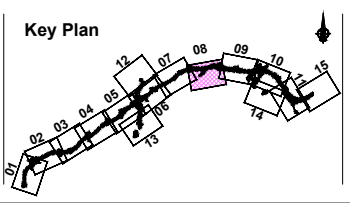

**Consultant**

Corporate House  
City East Business Park  
Ballybrit, Galway, Ireland.

Tel +353 (0)91 460675  
www.NGalwayCity.ie  
www.arup.ie

**Job Title**  
N6 Galway City Ring Road

**Scale**  
1:5000 @ A3

**Date:**  
February 2018

Issue	Date	By	Chkd	Appd
11	22/02/2018	KJ	MH	EMC

**Drawing Title**  
Existing ESB, Gas & Telecom Utilities Network Plan  
CH.10+550 to CH.12+200  
Sheet 8 of 15

**Drawing Status**  
For Information

Job No	Drawing No	Issue
233985	GCOB-2700-D-008	11



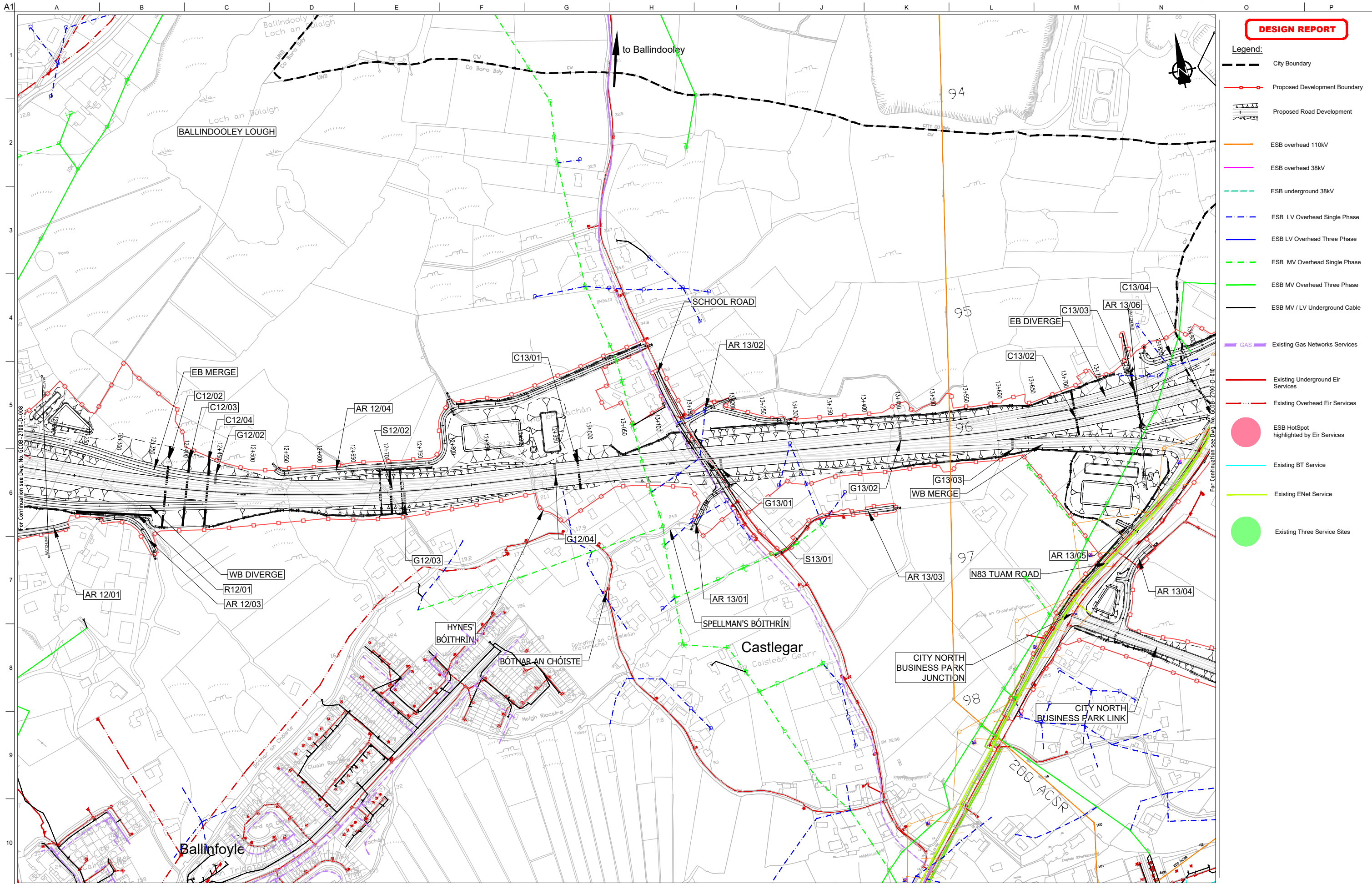

**DESIGN REPORT**

- Legend:**
- City Boundary
  - Proposed Development Boundary
  - Proposed Road Development
  - ESB overhead 110kV
  - ESB overhead 38kV
  - ESB underground 38kV
  - ESB LV Overhead Single Phase
  - ESB LV Overhead Three Phase
  - ESB MV Overhead Single Phase
  - ESB MV Overhead Three Phase
  - ESB MV / LV Underground Cable
  - GAS Existing Gas Networks Services
  - Existing Underground Eir Services
  - Existing Overhead Eir Services
  - ESB HotSpot highlighted by Eir Services
  - Existing BT Service
  - Existing ENet Service
  - Existing Three Service Sites

Son áiríamh tá sonraíochtaí Shairbhéireachtaí Ordánais Éireann arna aistriú go dtailí físe Chreatnais OSI Uimh. 2010/18CCMA/Comhairle Contae na Gaillimhe. Sáráilom aistriú go dtailí físe na hÉireann. © Sairbhéireachtaí Ordánais Éireann, 2010.

© Sairbhéireachtaí Ordánais Éireann. Gach ceart ar chosaint. Uimhir cheadnáis 2010/18CCMA/Comhairle Contae na Gaillimhe.

Includes Ordnance Survey Ireland data reproduced under OSI Licence number 2010/18CCMA/Galway County Council. Unauthorised reproduction infringes Ordnance Survey Ireland and Government of Ireland copyright. © Ordnance Survey Ireland, 2010.

© Ordnance Survey Ireland. All rights reserved. Licence number 2010/18CCMA/Galway County Council.

**Clients**

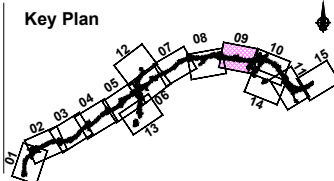

**Consultant**

Corporate House  
City East Business Park  
Ballybrit, Galway, Ireland.

Tel +353 (0)91 460675  
www.N6GalwayCity.ie  
www.arup.ie

**Job Title**  
N6 Galway City Ring Road

**Scale**  
1:5000 @ A3

**Date:**  
February 2018

Issue	Date	By	Chkd	Appd
11	22/02/2018	KJ	MH	EMC

**Drawing Title**  
Existing ESB, Gas & Telecom Utilities Network Plan  
CH.12+200 to CH.13+800  
Sheet 9 of 15

**Drawing Status**  
For Information

Job No	Drawing No	Issue
233985	GC0B-2700-D-009	11

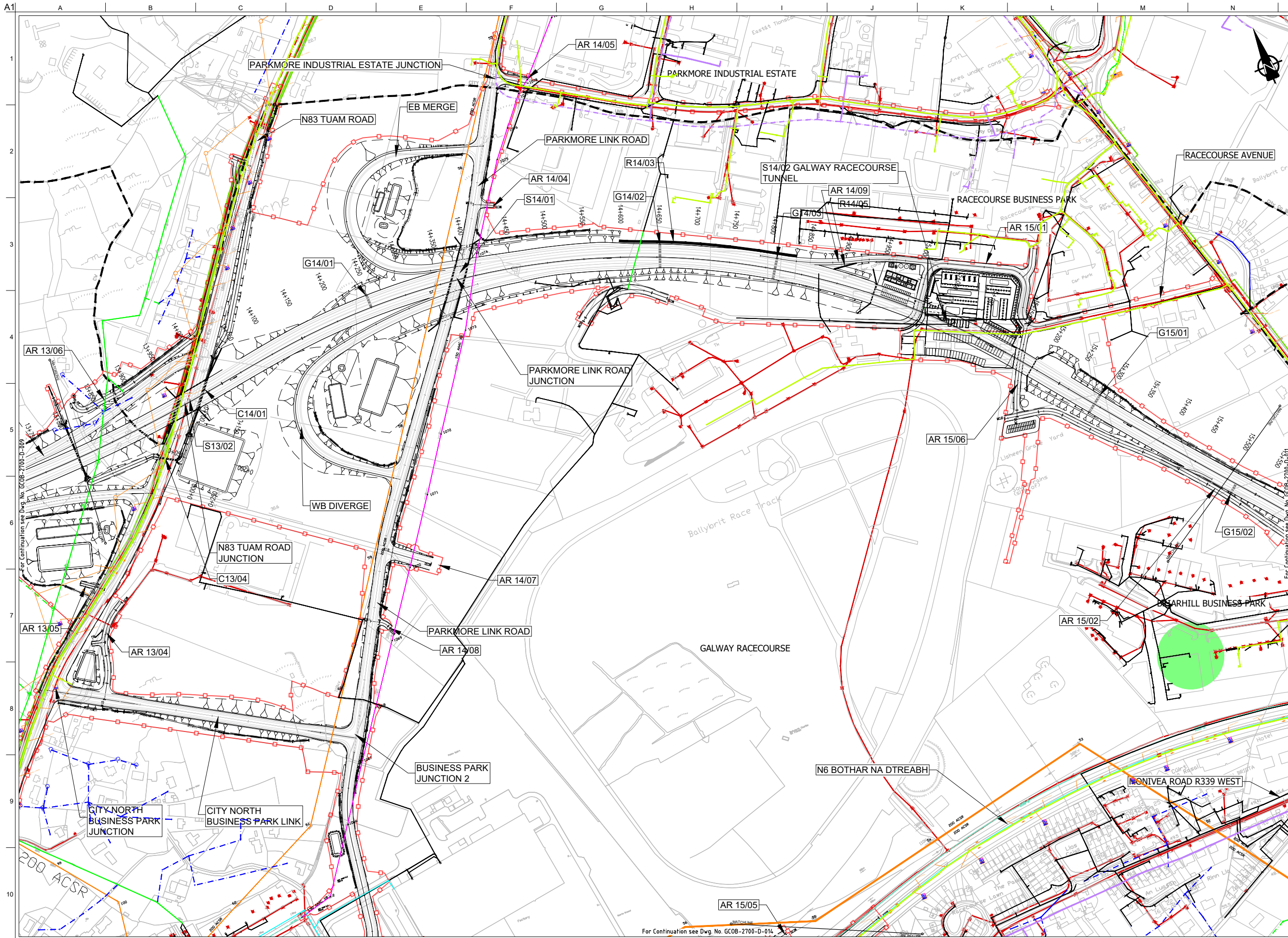

**DESIGN REPORT**

- Legend:**
- City Boundary
  - Proposed Development Boundary
  - Proposed Road Development
  - ESB overhead 110kV
  - ESB overhead 38kV
  - ESB underground 38kV
  - ESB LV Overhead Single Phase
  - ESB LV Overhead Three Phase
  - ESB MV Overhead Single Phase
  - ESB MV Overhead Three Phase
  - ESB MV / LV Underground Cable
  - GAS Existing Gas Networks Services
  - Existing Underground Eir Services
  - Existing Overhead Eir Services
  - ESB HotSpot highlighted by Eir Services
  - Existing BT Service
  - Existing ENet Service
  - Existing Three Service Sites

San áiríamh tá sonraíochtaí Shairbhéireachtaí Ordánais Éireann arna aistriú go dtailíú físiúil Cheadúnas OSI Uimh. 2010/18CCMA/Comhairle Contae na Gaillimhe. Sárúil ar aistriú go dtailíú naimhdearthaí na císchearta Shairbhéireachtaí Ordánais Éireann agus Rialtas na hÉireann. © Sairbhéireachtaí Ordánais Éireann, 2010.

© Sairbhéireachtaí Ordánais Éireann. Gach ceart ar chosaint. Uimhir cheadúnais 2010/18CCMA/Comhairle Contae na Gaillimhe.

Includes Ordnance Survey Ireland data reproduced under OSI Licence number 2010/18CCMA/Galway County Council. Unauthorised reproduction infringes Ordnance Survey Ireland and Government of Ireland copyright. © Ordnance Survey Ireland, 2010.

© Ordnance Survey Ireland. All rights reserved. Licence number 2010/18CCMA/Galway County Council.

**Clients**

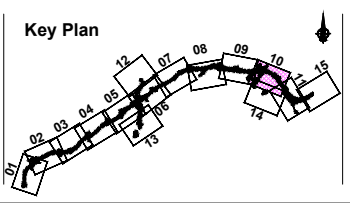

**Consultant**

Corporate House  
City East Business Park  
Ballybrit, Galway, Ireland.

Tel +353 (0)91 460675  
www.NGalwayCity.ie  
www.arup.ie

**Job Title**  
N6 Galway City Ring Road

**Scale**  
1:5000 @ A3

**Date:**  
February 2018

Drawing Information				
Issue	Date	By	Chkd	Appd
11	22/02/2018	KJ	MH	EMC

For Information		
Job No	Drawing No	Issue
233985	GC0B-2700-D-010	11

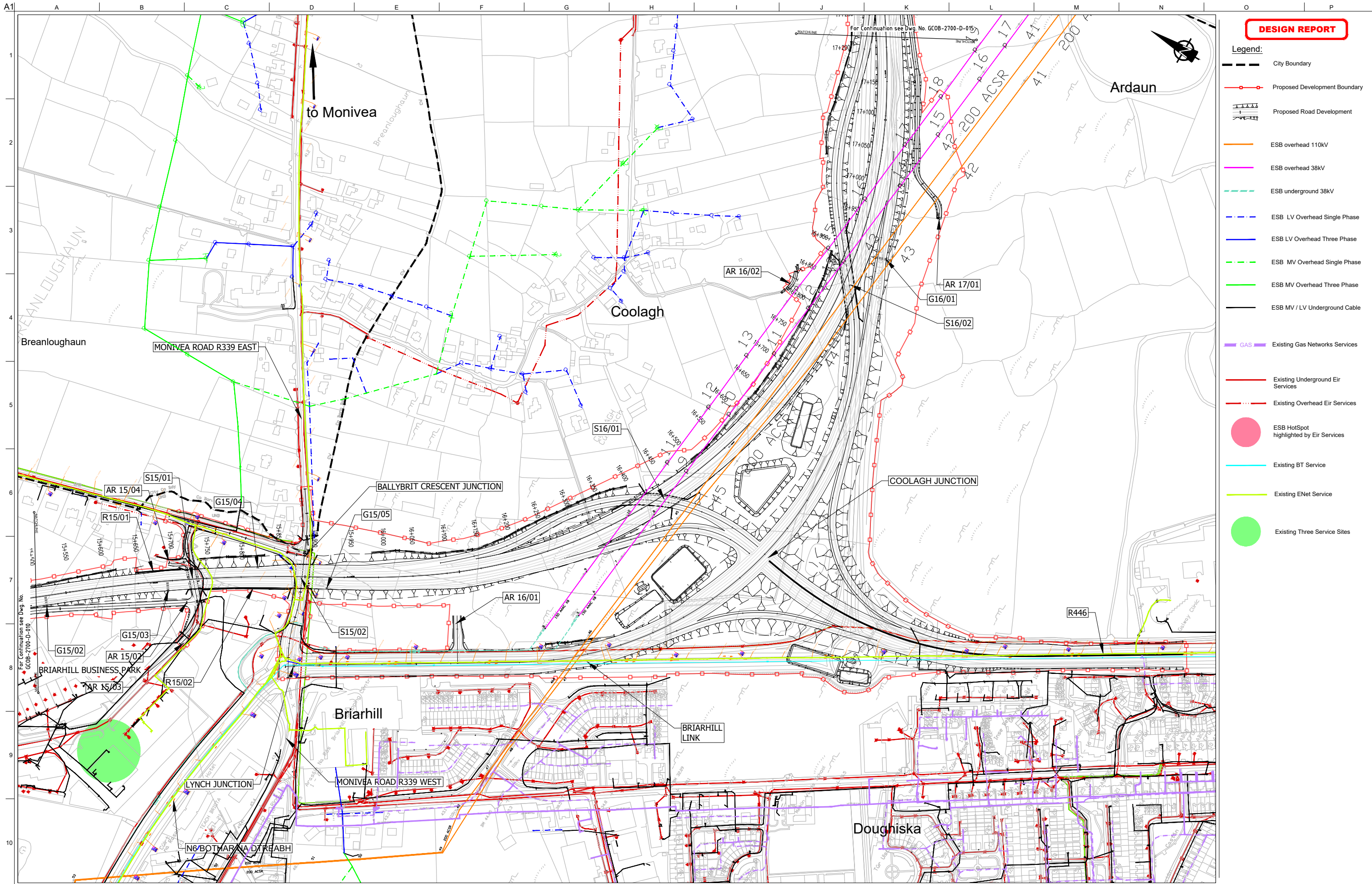

**DESIGN REPORT**

- Legend:**
- City Boundary
  - Proposed Development Boundary
  - Proposed Road Development
  - ESB overhead 110kV
  - ESB overhead 38kV
  - ESB underground 38kV
  - ESB LV Overhead Single Phase
  - ESB LV Overhead Three Phase
  - ESB MV Overhead Single Phase
  - ESB MV Overhead Three Phase
  - ESB MV / LV Underground Cable
  - GAS Existing Gas Networks Services
  - Existing Underground Eir Services
  - Existing Overhead Eir Services
  - ESB HotSpot highlighted by Eir Services
  - Existing BT Service
  - Existing ENet Service
  - Existing Three Service Sites

San áiríamh tá sonraíochtaí Shairbhéireachtaí Ordánais Éireann arna aistriú go dtailí faoi Chosúnaíocht OSI Umh. 2010/18CCMA/Comhairle Contae na Gaillimhe. Sárúilom aistriú go dtailí na sonraíochtaí Shairbhéireachtaí Ordánais Éireann agus Rialtas na hÉireann. © Sairbhéireachtaí Ordánais Éireann, 2010.

© Sairbhéireachtaí Ordánais Éireann. Gach coart ar chosaint. Uimhir cheadainis 2010/18CCMA/Comhairle Contae na Gaillimhe.

Includes Ordnance Survey Ireland data reproduced under OSI Licence number 2010/18CCMA/Galway County Council. Unauthorised reproduction infringes Ordnance Survey Ireland and Government of Ireland copyright. © Ordnance Survey Ireland, 2010.

© Ordnance Survey Ireland. All rights reserved. Licence number 2010/18CCMA/Galway County Council.

**Clients**

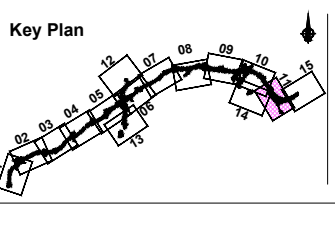

**Consultant**

Corporate House  
City East Business Park  
Ballybrit, Galway, Ireland.

Tel +353 (0)91 460675  
www.NGalwayCity.ie  
www.arup.ie

**Job Title**  
N6 Galway City Ring Road

**Scale**  
1:5000 @ A3

**Date:**  
February 2018

Drawing Title				
Existing ESB, Gas & Telecom Utilities Network Plan CH.15+500 to CH.17+540 ( End of Scheme ) Sheet 11 of 15				
Drawing Status				
For Information				
Job No	Drawing No	Issue		
233985	GC0B-2700-D-011	11		

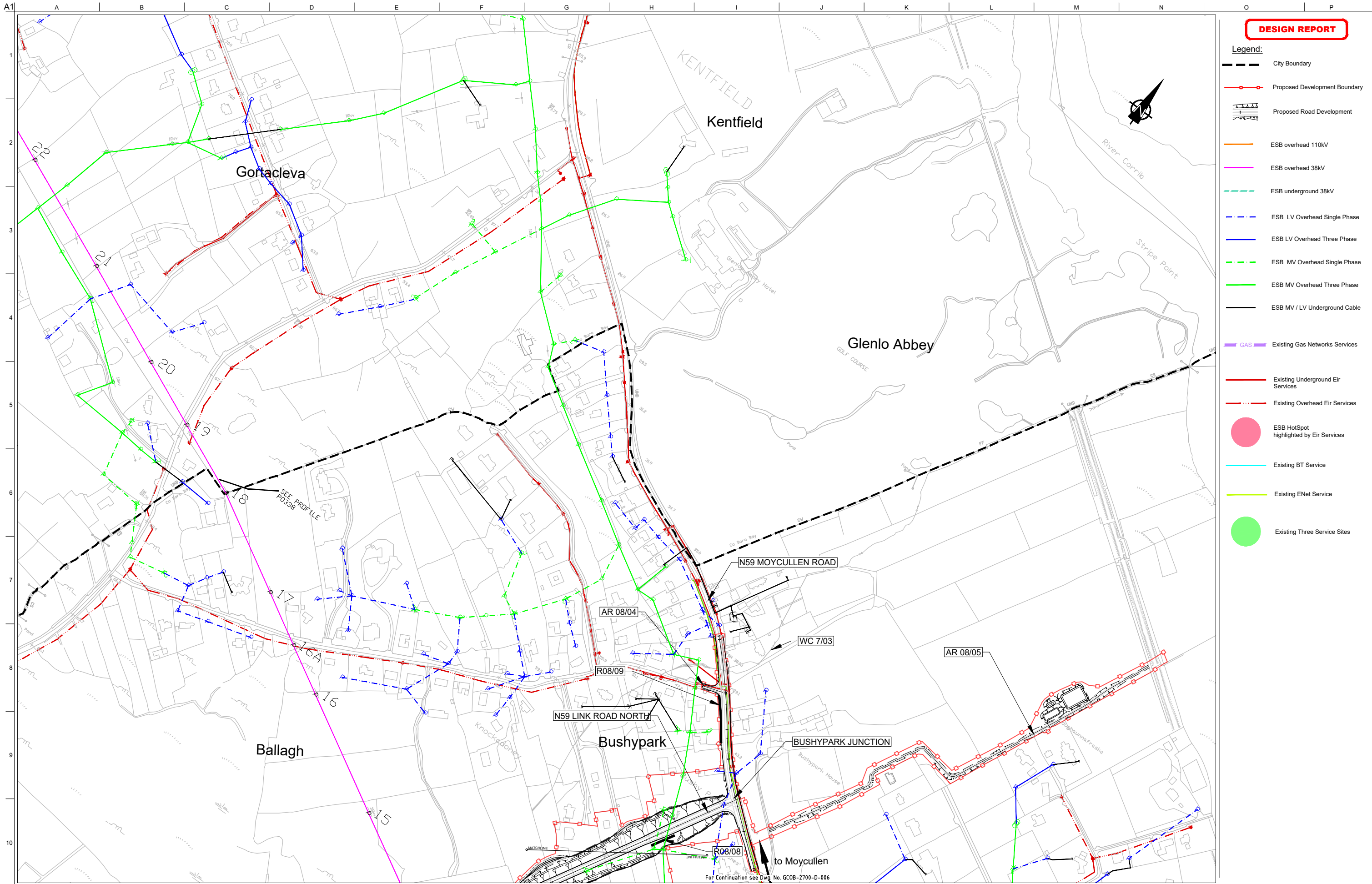

**DESIGN REPORT**

- Legend:**
- City Boundary
  - Proposed Development Boundary
  - Proposed Road Development
  - ESB overhead 110kV
  - ESB overhead 38kV
  - ESB underground 38kV
  - ESB LV Overhead Single Phase
  - ESB LV Overhead Three Phase
  - ESB MV Overhead Single Phase
  - ESB MV Overhead Three Phase
  - ESB MV / LV Underground Cable
  - GAS Existing Gas Networks Services
  - Existing Underground Eir Services
  - Existing Overhead Eir Services
  - ESB HotSpot highlighted by Eir Services
  - Existing BT Service
  - Existing ENet Service
  - Existing Three Service Sites

San áiríamh tá sonraíochtaí Shairbhéireachtaí Ordánáis Éireann arna aistriú go dtailí físiú Chéadainn OSI Uimh. 2010/18CCMA/Comhairle Contae na Gaillimhe. Sáráilom aistriú go dtailí naomháráil na císchearta Shairbhéireachtaí Ordánáis Éireann agus Rialtas na hÉireann. © Shairbhéireachtaí Ordánáis Éireann, 2010.

© Shairbhéireachtaí Ordánáis Éireann. Gach ceart ar chosaint. Uimhir cheadainnais 2010/18CCMA/Comhairle Contae na Gaillimhe.

Includes Ordnance Survey Ireland data reproduced under OSI Licence number 2010/18CCMA/Galway County Council. Unauthorised reproduction infringes Ordnance Survey Ireland and Government of Ireland copyright. © Ordnance Survey Ireland, 2010.

© Ordnance Survey Ireland. All rights reserved. Licence number 2010/18CCMA/Galway County Council.

**Clients**

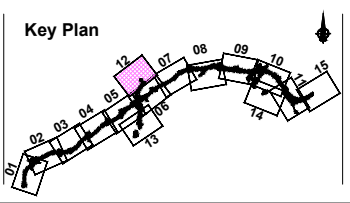

**Consultant**

Corporate House  
City East Business Park  
Ballybrit, Galway, Ireland.

Tel +353 (0)91 460675  
www.N6GalwayCity.ie  
www.arup.ie

**Job Title**  
N6 Galway City Ring Road

**Scale**  
1:5000 @ A3

**Date:**  
February 2018

Issue	Date	By	Chkd	Appd
11	22/02/2018	KJ	MH	EMC

**Drawing Title**  
Existing ESB, Gas & Telecom Utilities Network Plan  
N59 Link Road North  
Sheet 12 of 15

**Drawing Status**  
For Information

<b>Job No</b> 233985	<b>Drawing No</b> GCOB-2700-D-012	<b>Issue</b> 11
-------------------------	--------------------------------------	--------------------

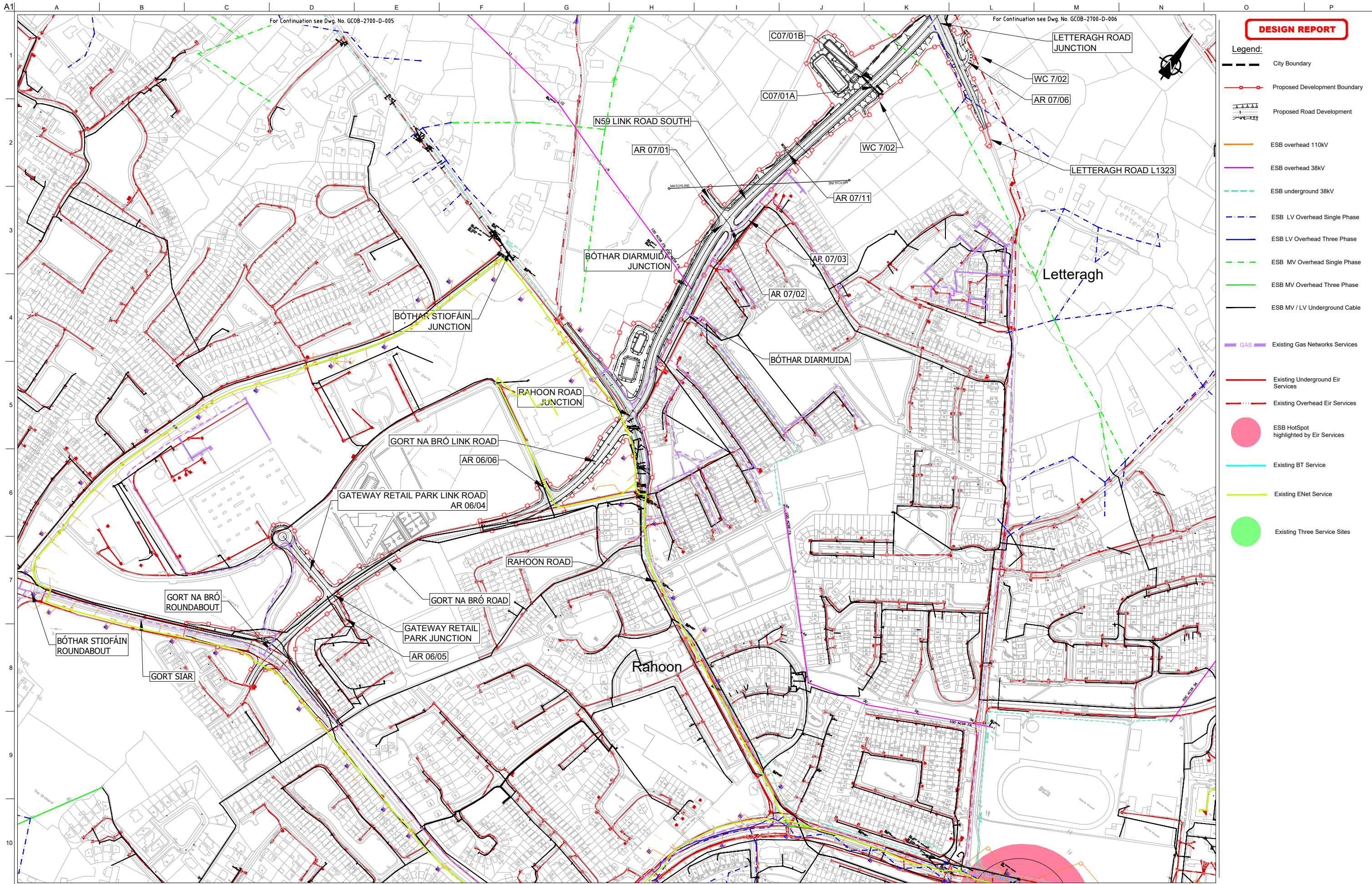

**DESIGN REPORT**

- Legend:**
- City Boundary
  - Proposed Development Boundary
  - Proposed Road Development
  - ESB overhead 110kV
  - ESB overhead 38kV
  - ESB underground 38kV
  - ESB LV Overhead Single Phase
  - ESB LV Overhead Three Phase
  - ESB MV Overhead Single Phase
  - ESB MV Overhead Three Phase
  - ESB MV / LV Underground Cable
  - GAS Existing Gas Networks Services
  - Existing Underground Eir Services
  - Existing Overhead Eir Services
  - ESB HotSpot highlighted by Eir Services
  - Existing BT Service
  - Existing ENet Service
  - Existing Three Service Sites

San áiríonn sé sonraíochtaí Shairbhíreacht Ordnáis Éireann arna áitirgeadh faoi Cheadúnas OSI Uimh. 2010/18CCMA/Comhairle Contae na Gaillimhe. Sáráilom áitirgeadh na mbhíreacht na císcheart Shairbhíreacht Ordnáis Éireann agus Rialtas na hÉireann. © Sairbhíreacht Ordnáis Éireann, 2010.

© Sairbhíreacht Ordnáis Éireann. Gach ceart ar chosaint. Uimhir cheadúnais 2010/18CCMA/Comhairle Contae na Gaillimhe.

Includes Ordnance Survey Ireland data reproduced under OSI Licence number 2010/18CCMA/Galway County Council. Unauthorised reproduction infringes Ordnance Survey Ireland and Government of Ireland copyright. © Ordnance Survey Ireland, 2010.

© Ordnance Survey Ireland. All rights reserved. Licence number 2010/18CCMA/Galway County Council.

**Clients**

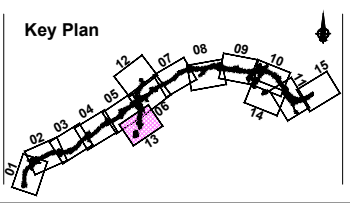

**Consultant**

Corporate House  
City East Business Park  
Ballybrit, Galway, Ireland.

Tel +353 (0)91 460675  
www.NGalwayCity.ie  
www.arup.ie

**Job Title**  
N6 Galway City Ring Road

**Scale**  
1:5000 @ A3

**Date:**  
February 2018

Issue	Date	By	Chkd	Appd
11	22/02/2018	KJ	MH	EMC

**Drawing Title**  
Existing ESB, Gas & Telecom Utilities Network Plan  
N59 Link Road South, Gateway Retail Park Junction  
Sheet 13 of 15

**Drawing Status**  
For Information

Job No	Drawing No	Issue
233985	GC0B-2700-D-013	11

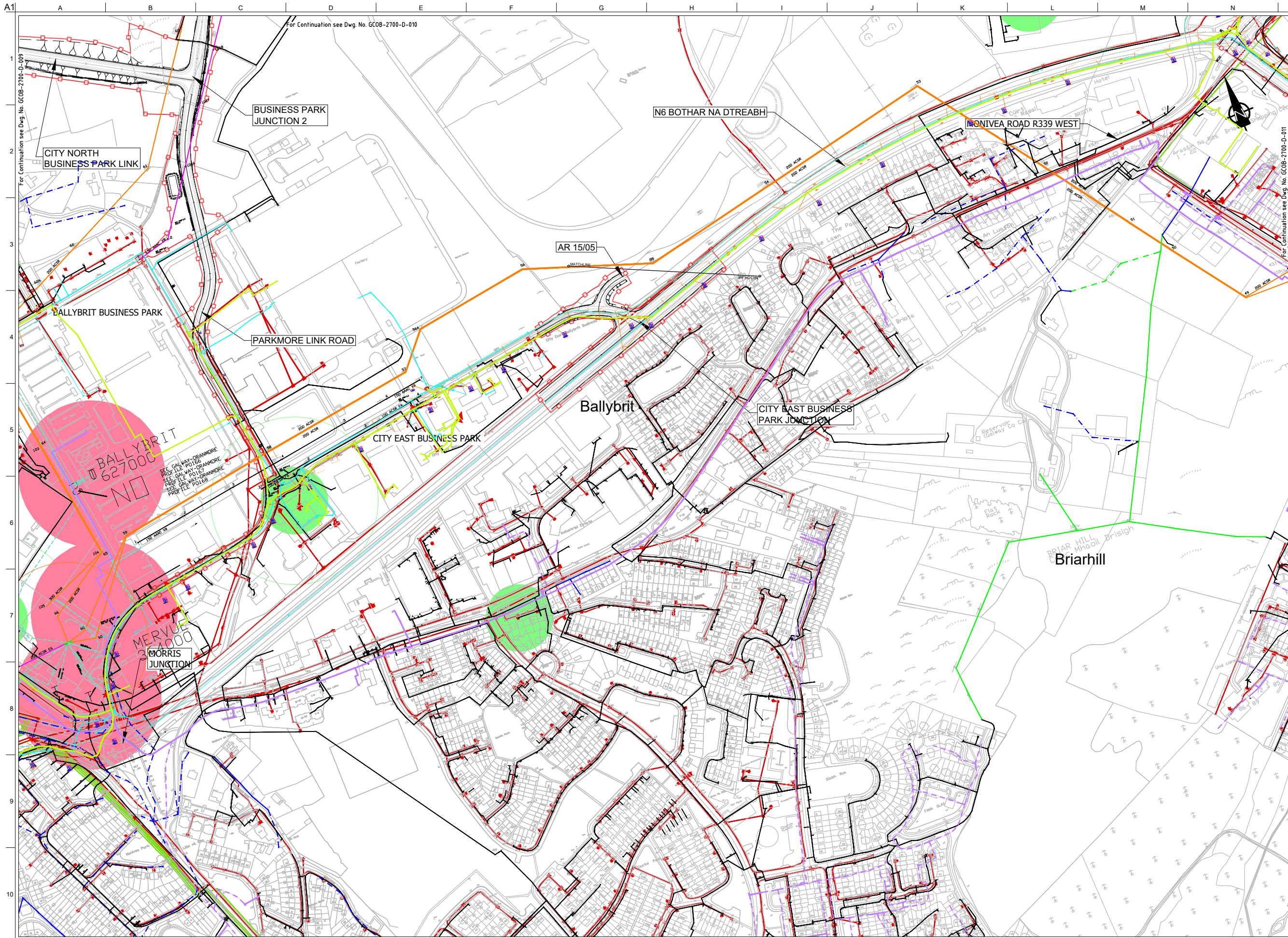

**DESIGN REPORT**

- Legend:**
- City Boundary
  - Proposed Development Boundary
  - Proposed Road Development
  - ESB overhead 110kV
  - ESB overhead 38kV
  - ESB underground 38kV
  - ESB LV Overhead Single Phase
  - ESB LV Overhead Three Phase
  - ESB MV Overhead Single Phase
  - ESB MV Overhead Three Phase
  - ESB MV / LV Underground Cable
  - GAS Existing Gas Networks Services
  - Existing Underground Eir Services
  - Existing Overhead Eir Services
  - ESB HotSpot highlighted by Eir Services
  - Existing BT Service
  - Existing ENet Service
  - Existing Three Service Sites

San áiríamh tá sonraíochtaí Shairbhéiríochtaí Ordánais Éireann arna aistriú go dtailí físiúcháin OSI Uimh. 2010/18CCMA/Comhairle Contae na Gaillimhe. Sáráilom aistriú go dtailí neamhdháraithe cóipeacht Shairbhéiríochtaí Ordánais Éireann agus Rialtas na hÉireann. © Sairbhéiríochtaí Ordánais Éireann, 2010.

© Sairbhéiríochtaí Ordánais Éireann. Gach coart ar chosaint. Uimhir cheadnáis 2010/18CCMA/Comhairle Contae na Gaillimhe.

Includes Ordnance Survey Ireland data reproduced under OSI Licence number 2010/18CCMA/Galway County Council. Unauthorised reproduction infringes Ordnance Survey Ireland and Government of Ireland copyright. © Ordnance Survey Ireland, 2010.

© Ordnance Survey Ireland. All rights reserved. Licence number 2010/18CCMA/Galway County Council.

Do not scale

\\global\europa\Dublin\Jobs\233000\233985-004\_Interna\4-02 Drawings\4-02-8 Highways\8.3 Design Rep\2700 Services & Accommodation Works\GOB-2700-D-000 to 015.dwg

**Clients**

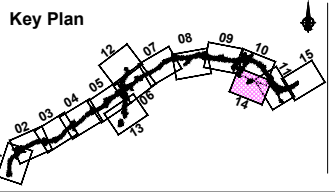

**Consultant**

Corporate House  
City East Business Park  
Ballybrit, Galway, Ireland.

Tel +353 (0)91 460675  
www.NGalwayCity.ie  
www.arup.ie

**Job Title**  
N6 Galway City Ring Road

**Scale**  
1:5000 @ A3

**Date:**  
February 2018

Issue	Date	By	Chkd	Appd
11	22/02/2018	KJ	MH	EMC

**Drawing Title**  
Existing ESB, Gas & Telecom Utilities Network Plan  
City East Junction  
Sheet 14 of 15

**Drawing Status**  
For Information

<b>Job No</b> 233985	<b>Drawing No</b> GOB-2700-D-014	<b>Issue</b> 11
-------------------------	-------------------------------------	--------------------

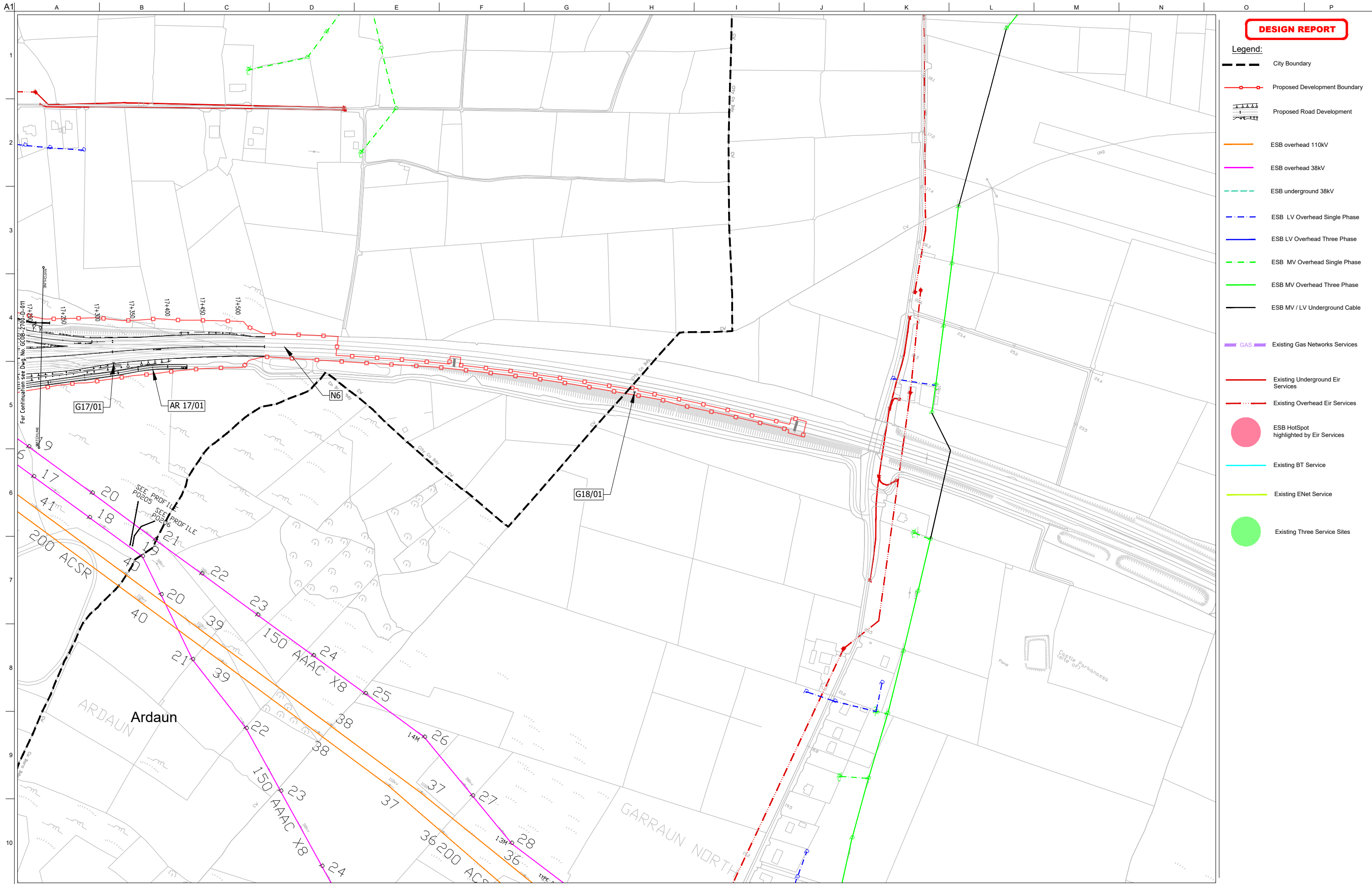

**DESIGN REPORT**

- Legend:**
- City Boundary
  - Proposed Development Boundary
  - Proposed Road Development
  - ESB overhead 110kV
  - ESB overhead 38kV
  - ESB underground 38kV
  - ESB LV Overhead Single Phase
  - ESB LV Overhead Three Phase
  - ESB MV Overhead Single Phase
  - ESB MV Overhead Three Phase
  - ESB MV / LV Underground Cable
  - GAS Existing Gas Networks Services
  - Existing Underground Eir Services
  - Existing Overhead Eir Services
  - ESB HotSpot highlighted by Eir Services
  - Existing BT Service
  - Existing ENet Service
  - Existing Three Service Sites

San áiríamh tá sonraíochtaí Shairbhéireacht Ordnáis Éireann arna aistriú go dtí físeánúis OSI Uimh. 2010/18CCMA/Comhairle Contae na Gaillimhe. Sáráilom aistriú go dtí na neamháráil na císchearta Shairbhéireacht Ordnáis Éireann agus Rialtas na hÉireann. © Sairbhéireacht Ordnáis Éireann, 2010.

© Sairbhéireacht Ordnáis Éireann. Gach ceart ar chosaint. Uimhir cheadnáis 2010/18CCMA/Comhairle Contae na Gaillimhe.

Includes Ordnance Survey Ireland data reproduced under OSI Licence number 2010/18CCMA/Galway County Council. Unauthorised reproduction infringes Ordnance Survey Ireland and Government of Ireland copyright. © Ordnance Survey Ireland, 2010.

© Ordnance Survey Ireland. All rights reserved. Licence number 2010/18CCMA/Galway County Council.

**Clients**

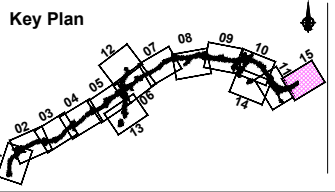

**Consultant**

Corporate House  
City East Business Park  
Ballybrit, Galway, Ireland.

Tel +353 (0)91 460675  
www.N6GalwayCity.ie  
www.arup.ie

**Job Title**  
N6 Galway City Ring Road

**Scale**  
1:5000 @ A3

**Date:**  
February 2018

Issue	Date	By	Chkd	Appd
11	22/02/2018	KJ	MH	EMC

**Drawing Title**  
Existing ESB, Gas & Telecom Utilities Network Plan CH.17+540 ( End of Scheme ) to Existing N6(-CH.18+550)  
Sheet 15 of 15

**Drawing Status**  
For Information

Job No	Drawing No	Issue
233985	GCOB-2700-D-015	11